



40 Ivy Bank Close, Penistone, Sheffield, South Yorkshire, S36 7GT

This amazing 5 bed detached house for sale in Penistone with double garage is an absolute must see, the location does not disappoint either, with Ingbirchworth Reservoir being literally round the corner,

Being tucked away in the corner of this stunning development is this beautiful home with spacious lounge, open plan dining/kitchen, utility room and downstairs WVC.

On the first floor you will find the master with en-suite, 2 further bedrooms, another en-suite, upstairs there are a further 2 bedrooms and another house bathroom.

Externally there is a double garage, off road parking and a well maintained enclosed rear garden, perfect for young children.

This home is perfect for any growing family and must be viewed to truly appreciate the space on offer.

The location is perfect and is close to Penistone town, motorway links and many scenic walks.

Book your viewing today for this 5 bed detached house for sale on Ivy Bank Close.

- Stunning 5 Bed Detached
- Double Garage & Off Road Parking
- Close to Nature Walks/Amenities/Commuter Links
- Must See

£475,000



Floor 0 Building 1



Floor 1 Building 1

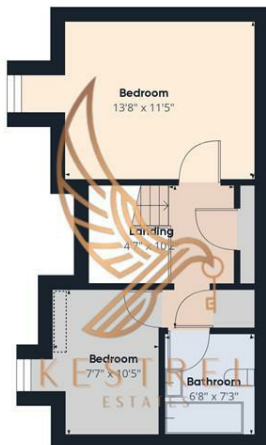

Floor 2 Building 1



Approximate total area^{RM}
1585.35 ft²

Reduced headroom
19.61 ft²

Excluding balconies and terraces

 Reduced headroom
(below 1.5m/4.92ft)

While every attempt has been made to ensure accuracy, all measurements are approximate, not to scale. This floor plan is for illustrative purposes only.

GIRAFFE360

